

Multiple Spindle
Boring Head

氣動式排鑽
PNEUMATIC LINE BORING HEAD

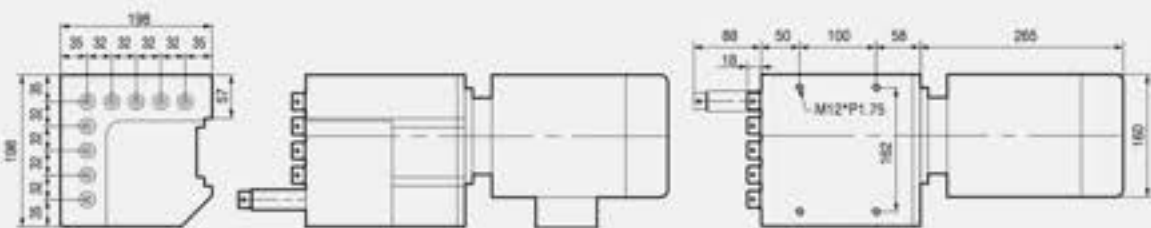

 龍格工業有限公司
LONG GER INDUSTRY CO., LTD.

台灣42241 台中市石岡區石城街58-6號
No.58-6, Shicheng St., Shigang Dist.,
Taichung City 42241, Taiwan
TEL:886-4-2572 3767 FAX:886-4-2572 3668
E-Mail : longgerbh@ms36.hinet.net
http://www.longger.com.tw

LONG GER AGGREGATE HEAD

龍格 複合刀頭

For Woodworking Applications



LONG GER

**HIGH PRECISION !
EXTRA SMOOTH RUNNING !**

HIGH PRECISION !
EXTRA SMOOTH RUNNING !
精密！ 運轉順暢！

LONG GER AGGREGATE HEAD

Your best choice in upgrading
efficiency and machining accuracy !

With over 20 years of total dedication in design and manufacturing of multiple spindle boring heads, Long Ger has successfully developed a wide range of high precision aggregate heads. These aggregate heads are designed to perform drilling, grooving and sawing operations at a time. With Long Ger new aggregate heads, you get increased machining accuracy, productivity and machining accuracy. Further more, they will help you create more profits.

LONG GER AGGREGATE HEAD

For Woodworking Applications

複合刀頭



龍格複合刀頭

提升效率與加工精度的最佳選擇！

龍格工業有限公司致力於精密多軸鑽孔頭，已有20多年歷史，歷經多年成功研發出廣泛系列的高精度複合刀頭。無論是鑽孔、銑槽、鋸切等加工作業，均可一次加工完成，為客戶大幅提升加工效率、產能與加工精度，更是創造利潤的好幫手。

RIGOROUS QUALITY CONTROL CREATES DEPENDABLE QUALITY

Insisting on quality-perfection is a tradition at Long Ger. Long Ger's aggregate heads are precision machined by using the advanced and sophisticated machining equipment. In addition, rigorous quality control is conducted at each step throughout the entire manufacturing process. With this comprehensive quality inspection, we can fully control quality of each part. This assures each aggregate head will exhibit exceptionally high accuracy, smooth running at high speed and minimum trouble.

嚴格品質控管 塑造信賴的品質

堅持完美的品質是龍格公司的一貫傳統。龍格複合刀頭除了採用先進高精度加工設備加工，在整個加工流程中的每一步驟，都依據最嚴格的品質標準，徹底掌控品質，以確保每一個複合刀頭，都將展現卓越特出的高精度、高速運轉順暢及最低故障率。

SINGLE OUTPUT SPINDLE 單軸

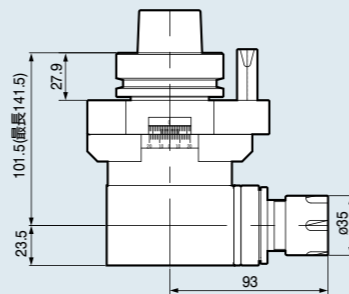
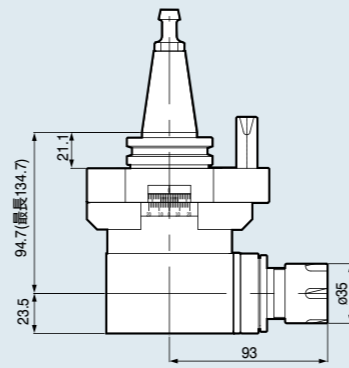

LONG GER
AGGREGATE HEAD

For Woodworking Applications

複合刀頭

FOUR OUTPUT SPINDLES 四軸

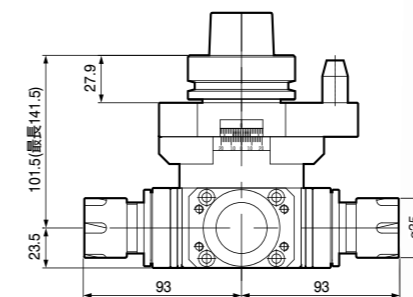
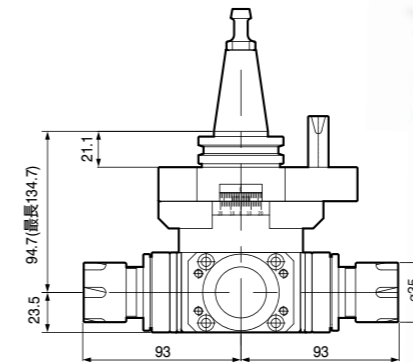

DOUBLE OUTPUT SPINDLES 雙軸



INCREASED LENGTH DOUBLE OUTPUT SPINDLES 加長型雙軸

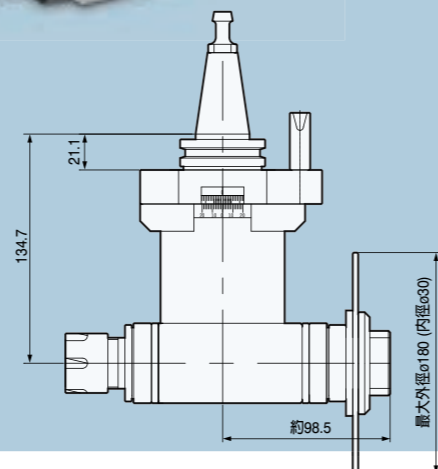
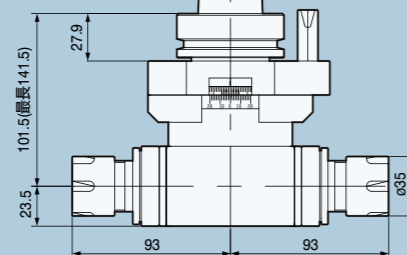
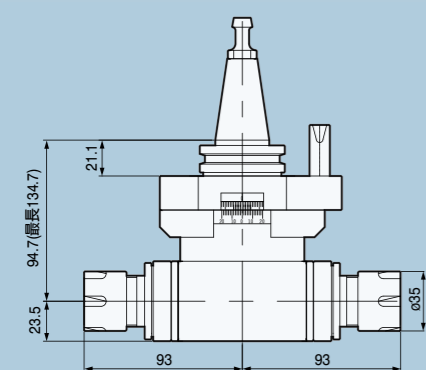

適用加工材質：

實木 / 密集板 / 塑合板
纖維板 / 塑膠 / 鋁材

加工型式：

側邊鑽孔、銑槽、鋸切

APPLICABLE MATERIALS :

Solid wood / MDF / Particle board
Fiber board / Plastic / Aluminum

MACHINING TYPES :

Side drilling, grooving and sawing.

ORDERING CODE 訂購型號

I	L	1D	1S
中心主軸錐度 CENTER SPINDLE TAPER	長度 LENGTH	鑽孔軸數 DRILLING SPINDLE NUMBERS	鋸切軸數 SAWING SPINDLE NUMBERS
I: ISO 30 H: HSK63F	S: 標準長 L: 加長型	1~4軸 D: 鑽孔銑槽軸 ER-25M軸	1~4軸 S: 鋸切軸 內孔 $\phi 30$, 迫緊式
	S: Standard length L: Increased length	1~4 output spindles D: Drilling grooving spindle ER-25 M spindle	1~4 output spindles S: Sawing spindle In side hole $\phi 30$, tightening type

ORDERING CODE 技術資料

最大輸入速度	Max. input speed	8000RPM
最大輸出速度	Max. output speed	11000RPM
齒輪轉速比	Gear ratio	1:1.42
彈性筒夾規格	Collet specif.	ER25-M($\phi 16$)
鋸片規格	Sawblade specif.	內孔 $\phi 30$, 最大直徑 $\phi 180$ (適用加長型) Inside hole $\phi 30$ max. dia. $\phi 180$ (For increased length model)
最大許可溫度	Max. temperature	85°C
重量	Weight	3.5 kgs ~ 5.8 Kgs

使用注意事項：

- 注意刀庫與主軸之荷重能力。
- 刀頭在高速運轉時，內部溫升非常高。刀頭之容許最高溫度為85°C。當達到容許溫度極限時，請將刀頭停止運轉，等待冷卻後，再啟動運轉，以延長刀頭壽命。

Notices When Using Aggregate Head :

- Pay attention to the loading capacity of tool magazine and spindle.
- During the aggregate head is running at high speed, thermal growth in the aggregate head is very high. Note that the allowable maximum temperature of the aggregate head is 85°C. When the thermal growth reaches the allowable temperature limit, stop its running. Wait until the aggregate head cool down then restarting running to extend its service life.

NOTICES WHEN ORDERING AGGREGATE HEAD 訂購注意事項

- 主軸錐度 Center spindle taper SK / ISO 30 HSK 63F
- 定位軸與主軸距離及尺寸(如右圖) Distance between positioning shaft and center spindle and sizes (shown as right figure) A: _____ B: _____
- 輸出軸數量 Numbers of output spindles : _____
加工狀況 Machining Condition :
鋸切 Sawing 鑽孔 Drilling
銑槽 Grooving 其它 Others
- 運轉時間 Running time : _____
- 使用轉速 Running speed : _____

LONG GER AGGREGATE HEAD

For Woodworking Applications

複合刀頭 - 其他類

Other Series

- 鑽頭數可指定
- 中心距固定
- 中心距可指定
- Drill numbers can be specified.
- Fixed center distance.
- Center distance can be specified.



ACCESSORIES 配件

